

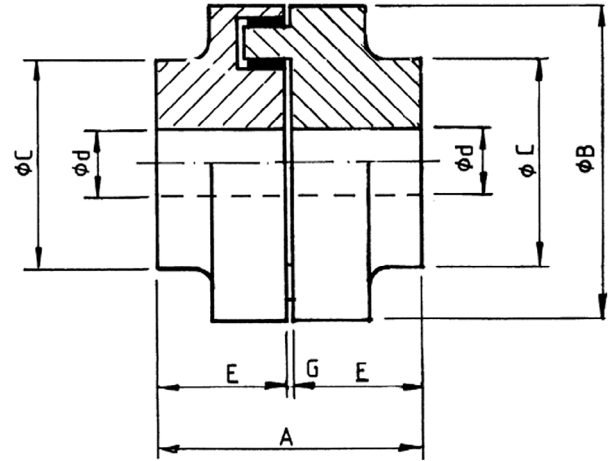

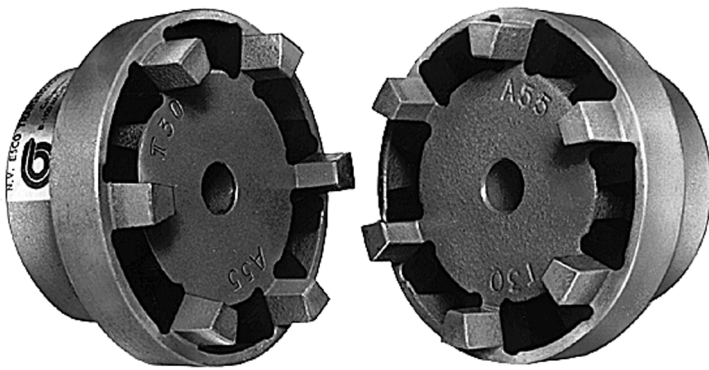



# ELASTIC COUPLINGS SERIES A

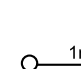

			Type												
			A28	A32	A38	A42	A48	A55	A60	A65	A75	A85	A90	A100	
	$d$ $\phi$ max.	1	mm	28	32	38	42	48	55	60	65	75	85	90	100
	$\phi$ min.	1.1	mm	9	9	14	14	18	18	24	26	32	42	42	48
	$M$	2	Nm	38	58	86	150	215	300	410	550	850	1350	2000	2850
	$n$ / min.max.	3	tr/min omw/min rpm min <sup>-1</sup>	5000	5000	5000	5000	5000	5000	5000	4900	4300	3700	3400	3000
	$J$ (WR <sup>2</sup> )	4	kgm <sup>2</sup>	0,0002	0,0004	0,0008	0,0013	0,0021	0,0035	0,0056	0,0087	0,014	0,026	0,045	0,080
	$G$	5	kg	0,9	1,4	2,0	2,7	3,7	5,5	6,9	8,8	13,5	19,5	23,2	31,9
$mm \pm$	A	mm	58	66	78	86	98	112	122	132	152	172	182	203	
	B	mm	69	78	87	96	106	118	129	140	158	182	200	224	
	C	mm	46	53	62	69	78	90	97	105	123	139	148	165	
	E	mm	28	32	38	42	48	55	60	65	75	85	90	100	
	G	mm	$2^{+1}_0$	$2^{+2}_0$	$2^{+2}_0$	$2^{+2}_0$	$2^{+3}_0$	$2^{+3}_0$	$2^{+3}_0$	$2^{+3}_0$	$2^{+3}_0$	$2^{+4}_0$	$2^{+4}_0$	$3^{+5}_0$	
$n$ 				16	16	20	20	24	24	24	24	24	24	24	24

# STANDARD SELECTION SERIE A

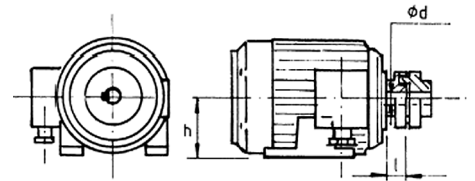

TYPE MOTEUR MOTOR « h »	3000	TYPE A	1500	TYPE A	1000	TYPE A	750	TYPE A	« d x l » (mm)	
	tr/min - min <sup>-1</sup> omw/min - rpm kW		tr/min - min <sup>-1</sup> omw/min - rpm kW		tr/min - min <sup>-1</sup> omw/min - rpm kW		tr/min - min <sup>-1</sup> omw/min - rpm kW		tr/min - min <sup>-1</sup> omw/min - rpm kW	3000
56	0,09	28	0,06	28					9 x 20	
	0,12	28	0,09	28						
63	0,18	28	0,12	28					11 x 23	
	0,25	28	0,18	28						
71	0,37	28	0,25	28					14 x 30	
	0,55	28	0,37	28						
80	0,75	28	0,55	28	0,37	28			19 x 40	
	1,1	28	0,75	28	0,55	28				
90 S	1,5	28	1,1	28	0,75	28			24 x 50	
90 L	2,2	28	1,5	28	1,1	28			24 x 50	
100 L	3	28	2,2	28	1,5	28	0,75	28	28 x 60	
			3	28			1,1	28		
112 M	4	28	4	28	2,2	28	1,5	28	28 x 60	
132 S	5,5	38	5,5	38	3	38	2,2	38	38 x 80	
	7,5	38								
132 M			7,5	38	4	38	3	38	38 x 80	
					5,5					
160 M	11	42	11	42	7,5	42	4	42	42 x 110	
	15	42					5,5	42		
160 L	18,5	42	15	42	11	42	7,5	42	42 x 110	
180 M	22	48	18,5	48					48 x 110	
180 L			22	48	15	48	11	48	48 x 110	
200 L	30	55	30	55	18,5	55	15	55	55 x 110	
	37	55			22	55				
225 S	45	55	37	60	30	60	18,5	60	55 x 110	60 x 140
225 M			45	60			22	60		
250 M	55	60	55	65	37	65	30	65	60 x 140	65 x 140
280 S	75	65	75	75	45	75	37	75	65 x 140	75 x 140
280 M	90	65	90	75	55	75	45	75		
315 S	110	65	110	85	75	85	55	85	65 x 140	80 x 170
315 M	132	75	132	85	90	85	75	85		
355 S					110	90	90	90	75 x 140	90 x 170
355 M	160	75	160	90	132	90	110	90		
355 L	200	85	200	90	160	100	132	100		
400 S	250	85	250	100	200	100	160	100	75 x 140	100 x 210
400 M	315	90	315	100	250	100	200	100		
450 M	400	90	400		315		250		80 x 170	100 x 210
450 L	500	100	500		400		315			